

VC-17 LAUREL WOODS ELEMENTARY SCHOOL VOTE CENTER – GYM 1 CHECK-IN

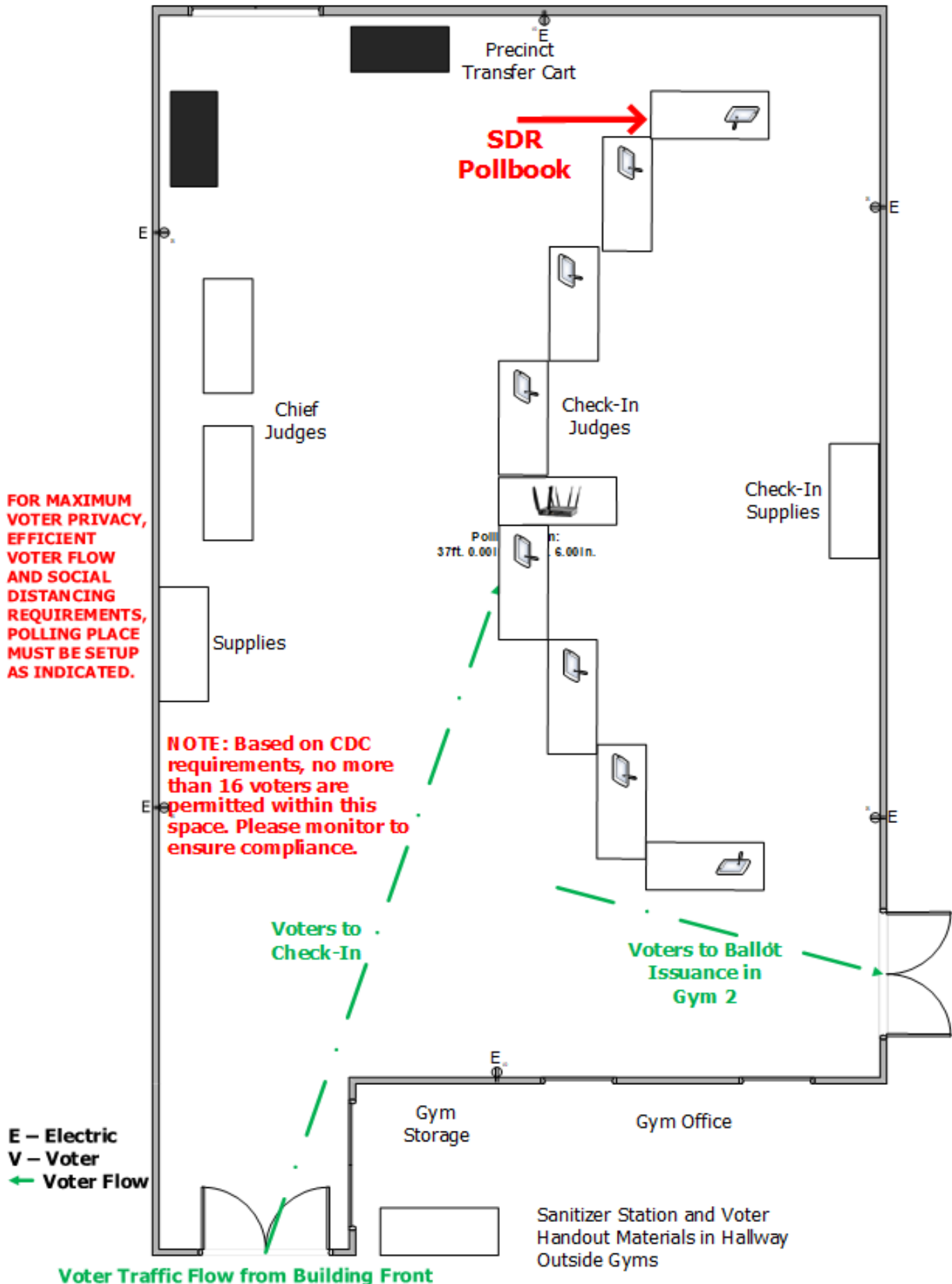

VC-17 LAUREL WOODS ELEMENTARY SCHOOL VOTE CENTER – GYM 2 VOTING

Please Space Voting Booths 6 Feet Apart

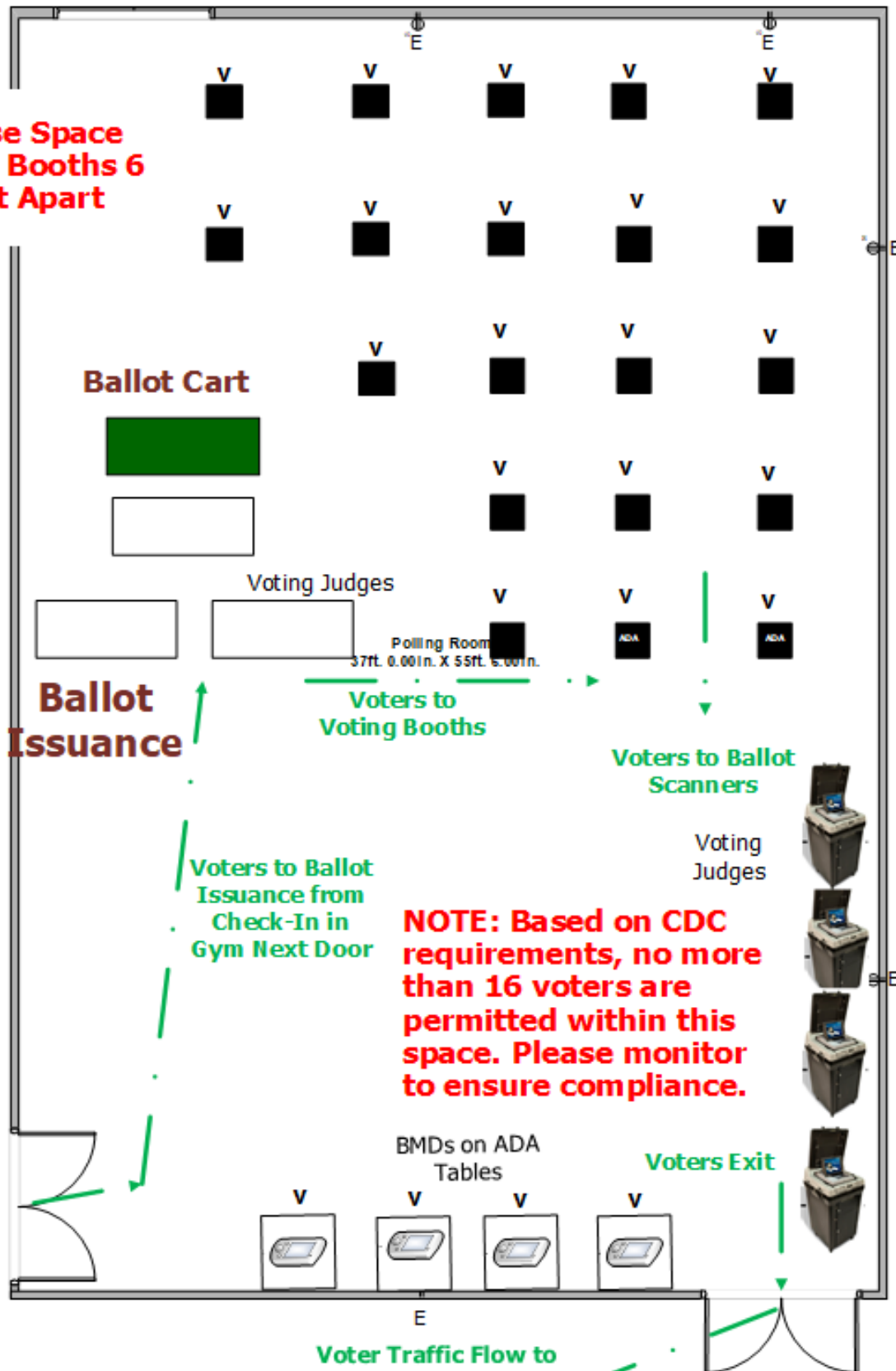

Ballot Issuance

Voting Judges

Polling Room
37ft. 0.00in. X 55ft. 5.00in.

Voters to Voting Booths

Voters to Ballot Scanners

Voting Judges

Voters to Ballot Issuance from Check-In in Gym Next Door

NOTE: Based on CDC requirements, no more than 16 voters are permitted within this space. Please monitor to ensure compliance.

BMDs on ADA Tables

Voters Exit

E – Electric
V – Voter
← Voter Flow

Voter Traffic Flow to Exit to Building Front

FOR MAXIMUM VOTER PRIVACY, EFFICIENT VOTER FLOW AND SOCIAL DISTANCING REQUIREMENTS, POLLING PLACE MUST BE SETUP AS INDICATED.