

VC-09 CENTENNIAL HIGH SCHOOL VOTE CENTER – CAFETERIA CHECK-IN

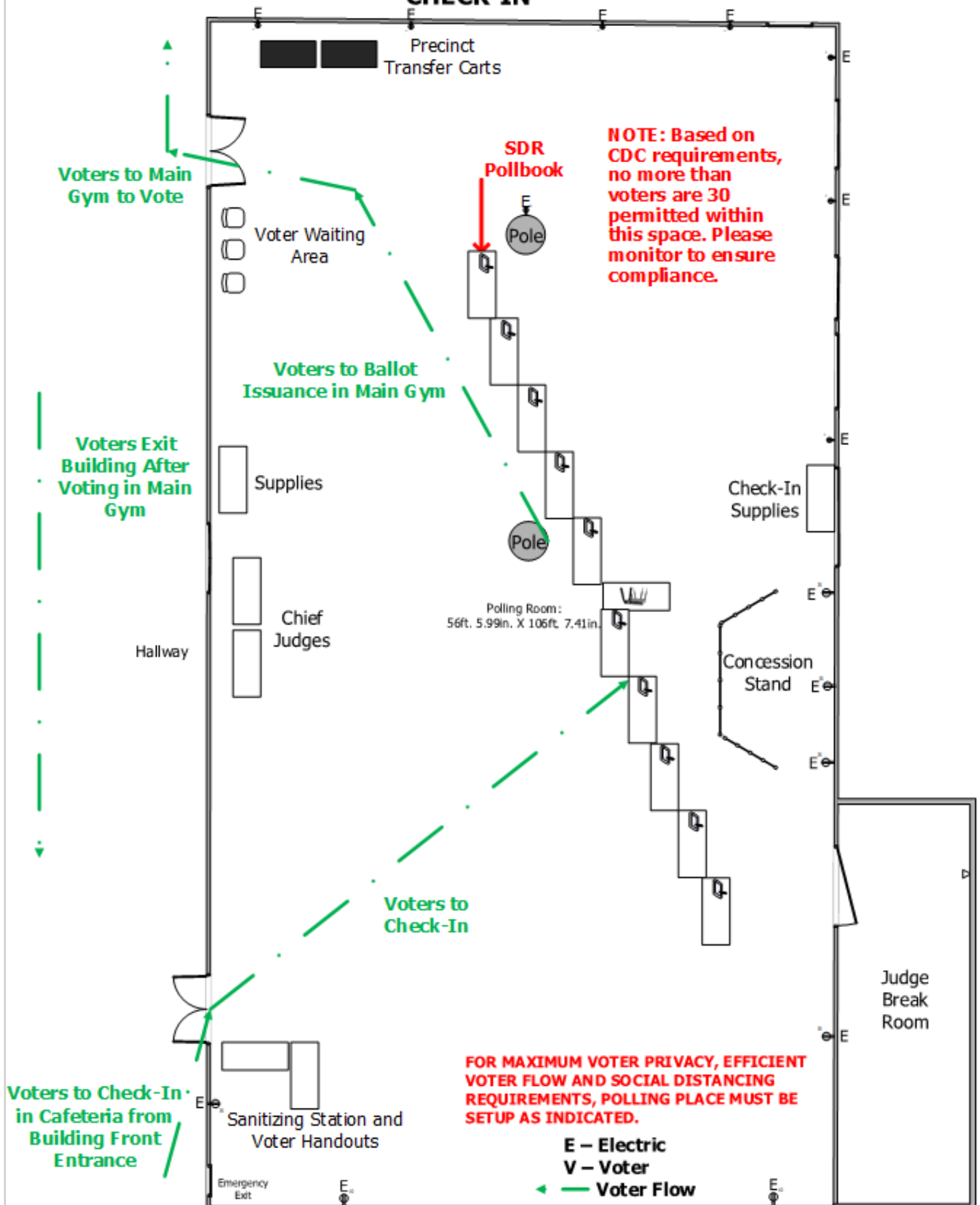

NOTE: Based on CDC requirements, no more than voters are 30 permitted within this space. Please monitor to ensure compliance.

FOR MAXIMUM VOTER PRIVACY, EFFICIENT VOTER FLOW AND SOCIAL DISTANCING REQUIREMENTS, POLLING PLACE MUST BE SETUP AS INDICATED.

SPECIAL CONSIDERATIONS: PLEASE PLACE DISABLED PARKING SIGNAGE NEAR MAIN VOTER ENTRANCE TO FRONT OF BUILDING. DO NOT BLOCK FIRE LANES!!! SIGNAGE WILL BE LOCATED IN ELECTION SUPPLY BOX IN CART.

VC-09 CENTENNIAL HIGH SCHOOL VOTE CENTER – MAIN GYM VOTING

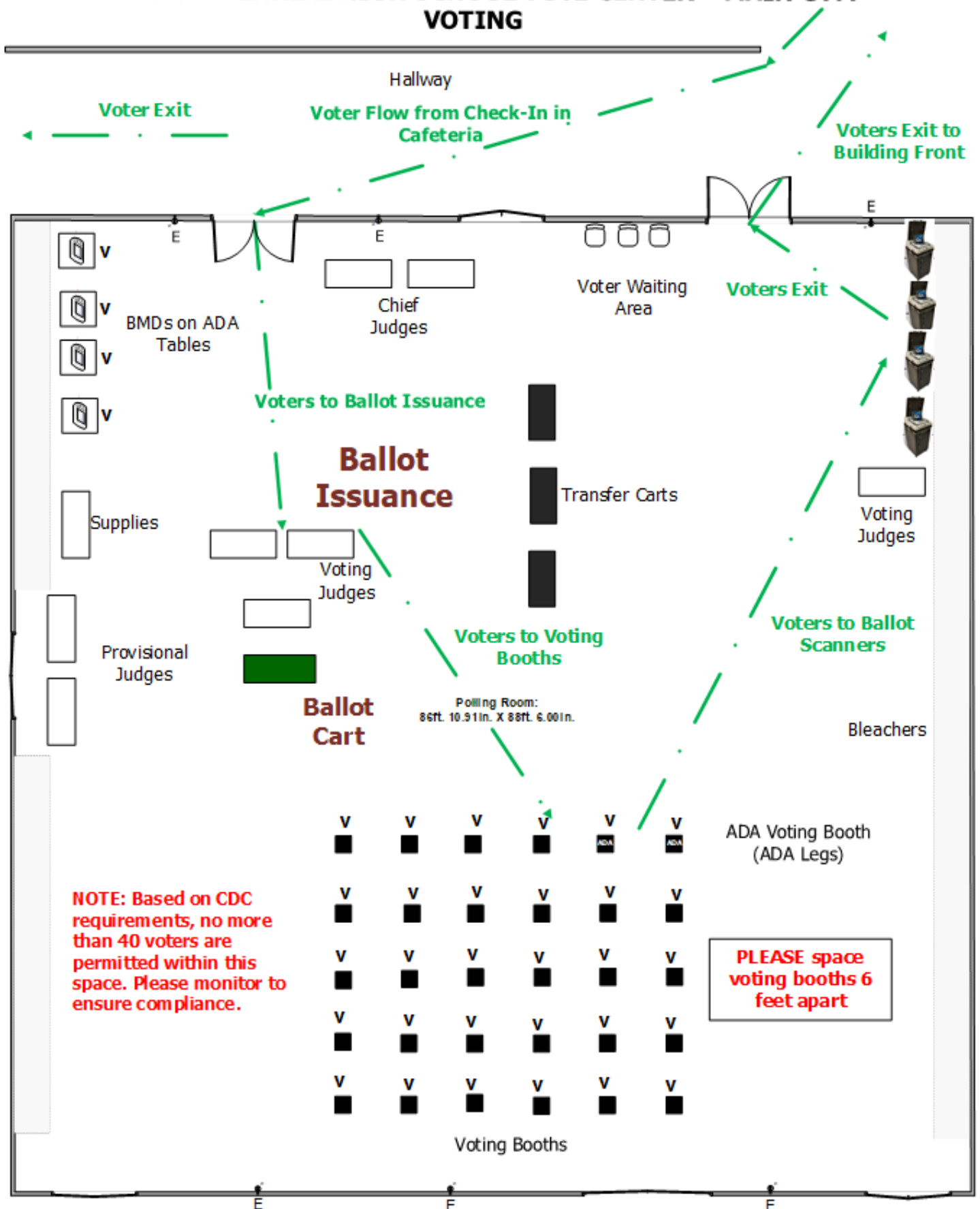

NOTE: Based on CDC requirements, no more than 40 voters are permitted within this space. Please monitor to ensure compliance.

PLEASE space voting booths 6 feet apart

FOR MAXIMUM VOTER PRIVACY, EFFICIENT VOTER FLOW AND SOCIAL DISTANCING REQUIREMENTS. POLLING PLACE MUST BE SETUP AS INDICATED. USE SUGGESTED CONFIGURATION FOR SETTING UP BOOTHS..

**E – Electric
V – Voter
← – Voter Flow**